

Soils Map

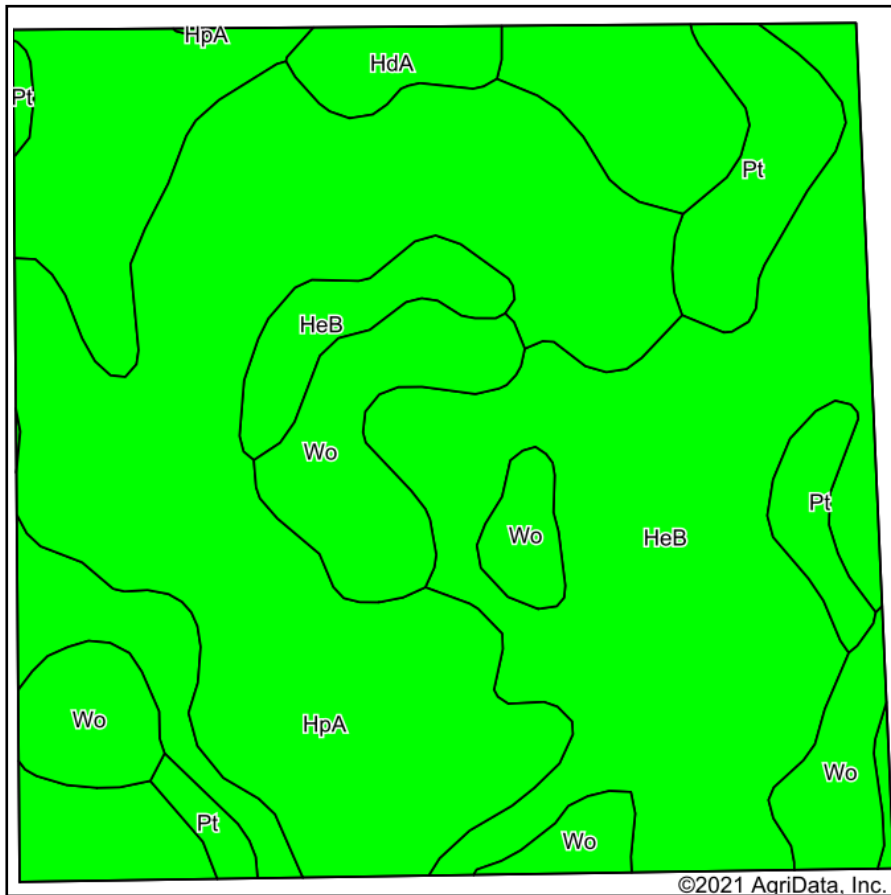

Soils data provided by USDA and NRCS.

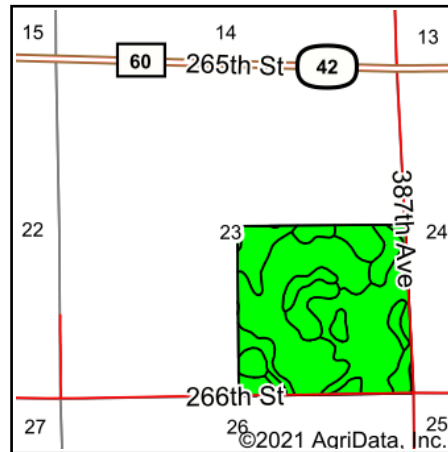

State: **South Dakota**
 County: **Aurora**
 Location: **23-101N-64W**
 Township: **Truro**
 Acres: **162**
 Date: **7/28/2021**



Maps Provided By:



© AgriData, Inc. 2021

www.AgriDataInc.com



Area Symbol: SD003, Soil Area Version: 26

Code	Soil Description	Acres	Percent of field	PI Legend	Non-Irr Class *c	Range Production (lbs/acre/yr)	Productivity Index	Corn	*n NCCPI Overall	*n NCCPI Corn	*n NCCPI Small Grains	*n NCCPI Soybeans
HeB	Houdek-Ethan loams, 2 to 6 percent slopes	73.80	45.6%		Ile	2939	70		59	43	36	59
HpA	Houdek-Prosper loams, 0 to 2 percent slopes	54.56	33.7%		IIc	3389	88		64	48	39	64
Wo	Worthing silty clay loam, 0 to 1 percent slopes	19.95	12.3%		Vw	6145	30		12	4	11	4
Pt	Plankinton-Prosper complex	10.54	6.5%		IVw	3512	67	22	32	19	25	31
HdA	Houdek-Dudley complex, 0 to 2 percent slopes	3.15	1.9%		IIc	2831	61		49	37	34	49
Weighted Average						3520.5	70.8	1.4	*n 52.9	*n 38.2	*n 33.2	*n 51.9

*n: The aggregation method is "Weighted Average using all components"

*c: Using Capabilities Class Dominant Condition Aggregation Method

Soils data provided by USDA and NRCS.